



## 安全警告 Safety Warning

- 为了保障您在娱乐时的安全，请在拼装之前阅读说明书。
  - 此产品适合 14 周岁及以上人群。儿童需在成人陪同下使用本产品。
  - 在未经授权的情况下擅自改变和修改本产品。将损害您有关产品的权益。
  - 不同类型的电池及新旧电池切勿混装。
  - 非充电电池不能充电。
- 
- For your safety during use, please read the instructions before assembly.
  - This product is suitable for ages 14 and above. Children must use the product under adult supervision.
  - Unauthorized modification or alteration of the product will void your warranty.
  - Do not install different types of batteries or new and used batteries together.
  - Non-rechargeable batteries must not be recharged.



## 注意事项 Attentions

- 请严格按照说明书的指示步骤进行拼装，切勿一次性将零件全部拆下，以免混淆。零件精细，拆卸需小心。
  - 本产品接插口的松紧程度是由加工工艺、环境温度决定的，接插部位如果过紧，可使用细砂纸轻轻打磨；如果接插口过松，可使用胶水固定。
  - 说明书上含有重要信息，请予以保存。
  - 电子套件已经事先组装好，请勿直接拆卸，否则易造成部分零件工作异常。
- 
- Follow the assembly steps in the manual precisely. Do not detach all parts at once to avoid confusion. Handle components carefully as they feature delicate parts.
  - Connector tightness varies based on manufacturing processes and ambient temperature. If connectors are excessively tight, lightly sand them with fine-grit sandpaper; if too loose, secure with adhesive.
  - Retain this manual as it contains essential information.
  - The electronic module assembly comes pre-assembled. Do not disassemble directly, as this may cause component malfunction.



## 维护和保养 Maintenance

- 请勿将本产品放置在靠近火源处，或其他任何易引发损害的地点。
  - 请勿使用酒精、氨水、等化学清洁剂来清洁本产品。
- 
- Do not place this product near a fire source or in any areas that are prone to causing damage.
  - Do not clean this product using chemical cleaners such as alcohol, ammonia, etc.

## 配件 Accessories



灯  
Lamp



磁铁  
Magnet

## 板材清单 Wood Block List



双面印刷图案  
Double sided pattern

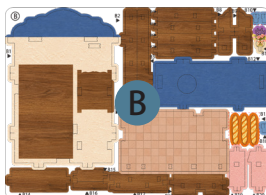

双面印刷图案  
Double sided pattern



单面印刷图案  
Printed on one side only

## 组装提示 Assembly Tips

- 整个书立内部将会分为下图几个部分，我们将按照更顺利的结构拼装逐一完成。最后组装在一起，完成整个书立。为了拼装的效果，需要保证面对正面都是有印刷颜色的面，让我们开始吧。
- The interior of the bookends will be divided into the sections shown in the figure below. We will assemble them step by step following a more logical structure, and finally combine all parts to complete the entire bookends. To ensure the best assembly results, please make sure the printed side always faces the front. Let's begin.

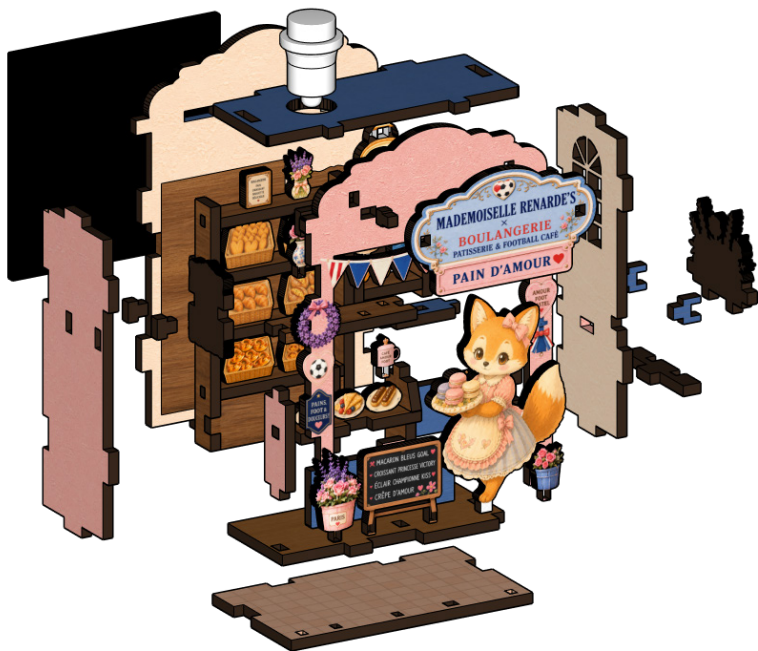

使用镊子夹取。  
Pick up with tweezers



此面有图案。  
There are patterns  
on this side.



用胶水固定。  
Reinforce with glue.



此面无图案。  
This side is blank

STEP1

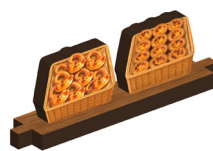
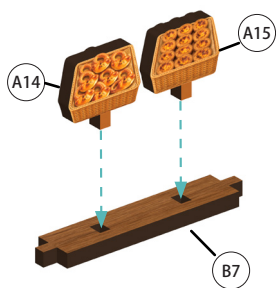

Z1

STEP2

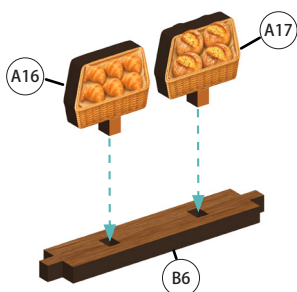

Z2

STEP3

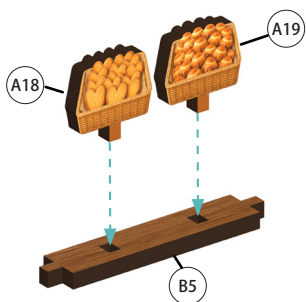

Z3

STEP4

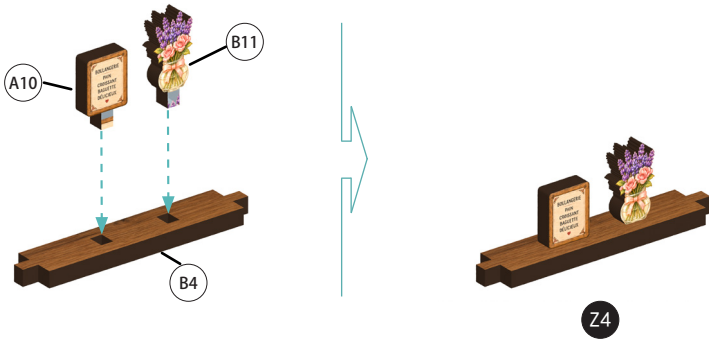

STEP5

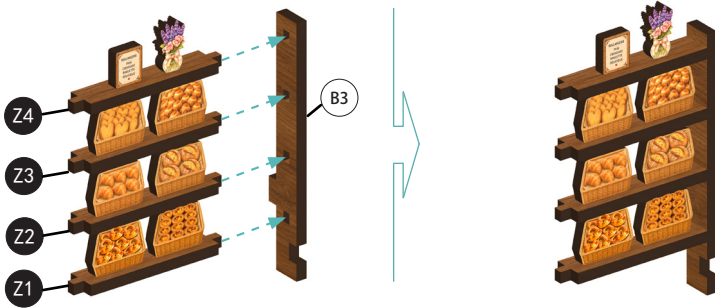

STEP6

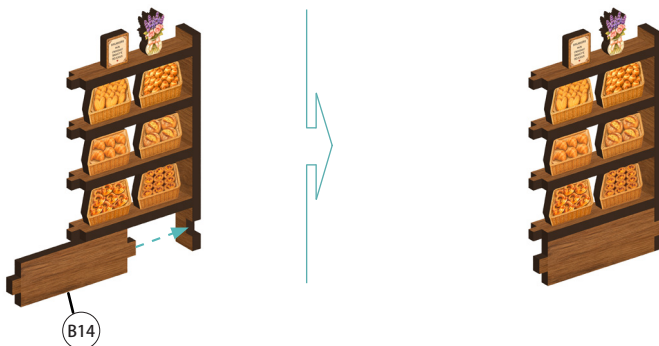

STEP7

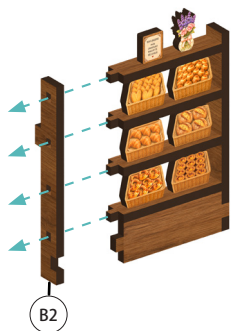

STEP8

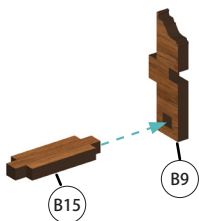

STEP9

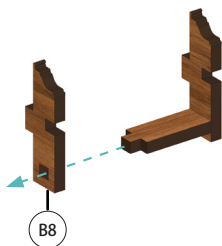

STEP10

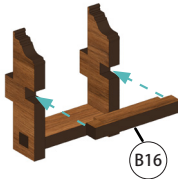

STEP11

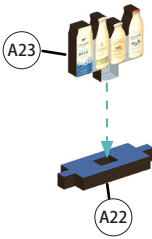

STEP12

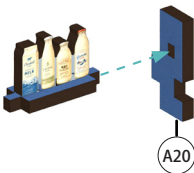

STEP13

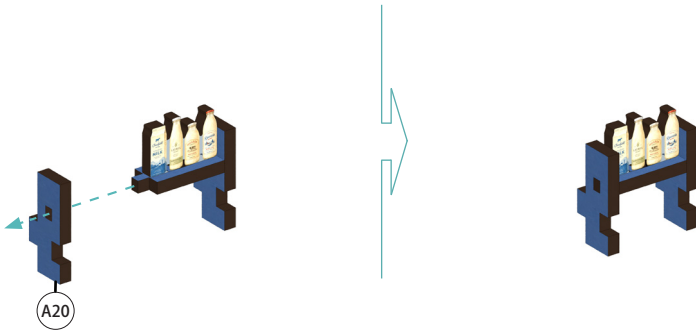

STEP14

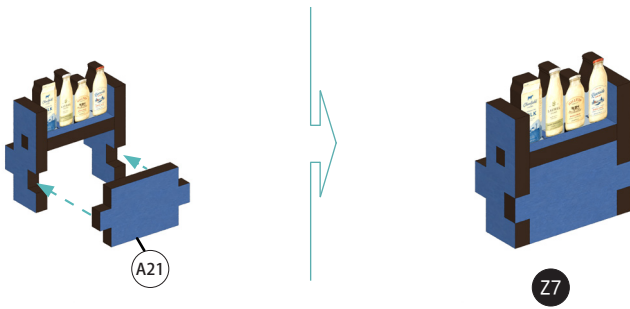

STEP16

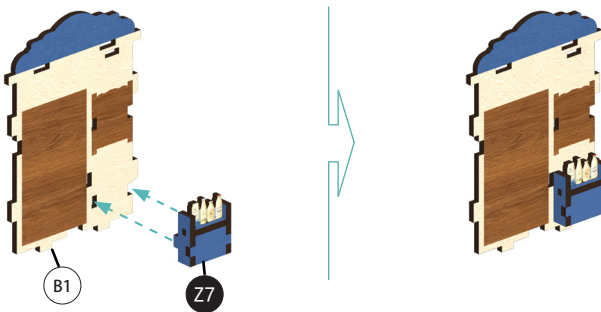

STEP17

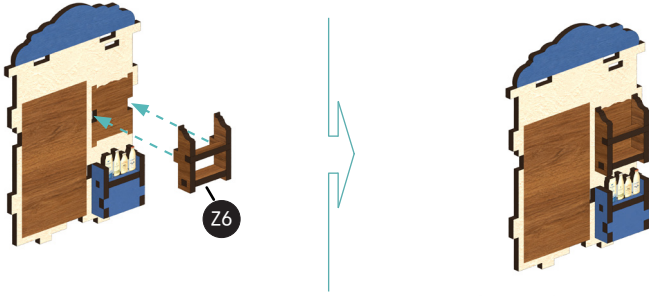

STEP18

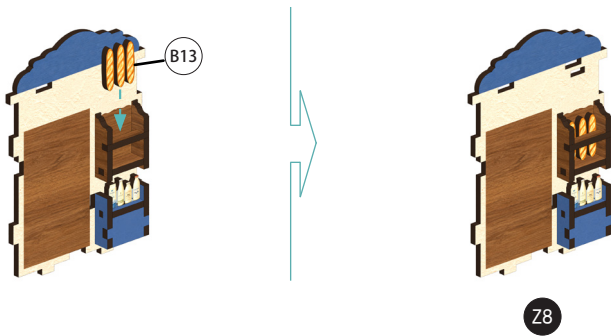

STEP19

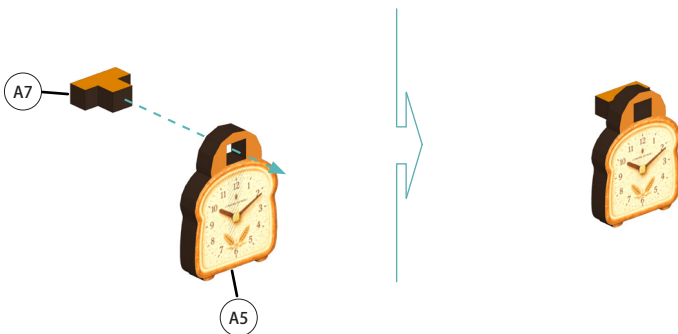

STEP20



STEP21



STEP22

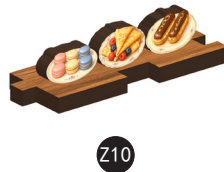
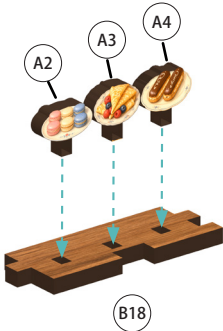

STEP23

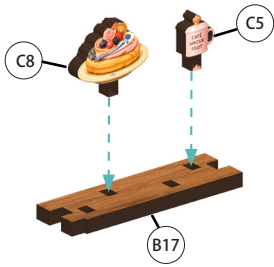

STEP24

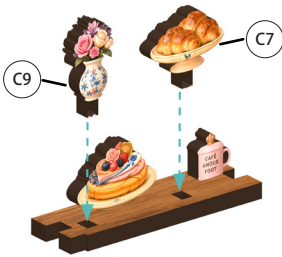

Z11

STEP25

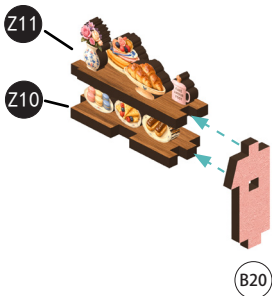

STEP26

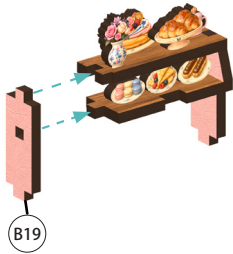

STEP27

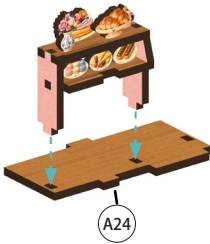

STEP28

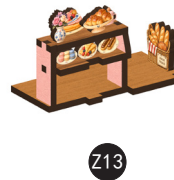
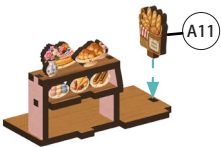

STEP30

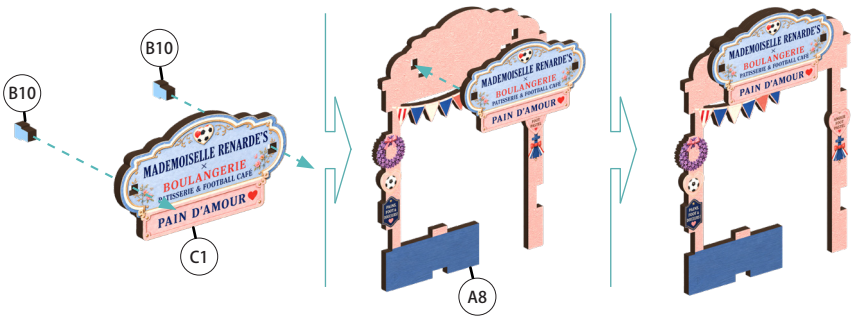

STEP31

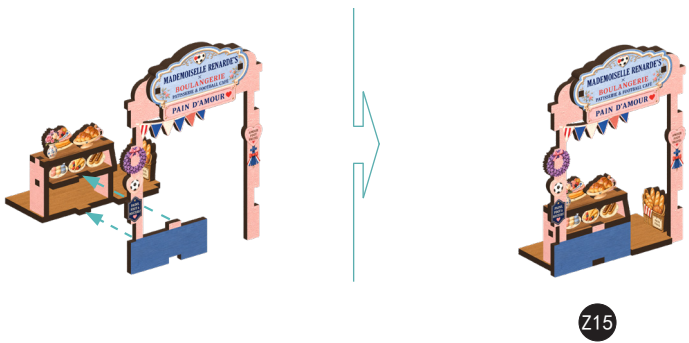

STEP32

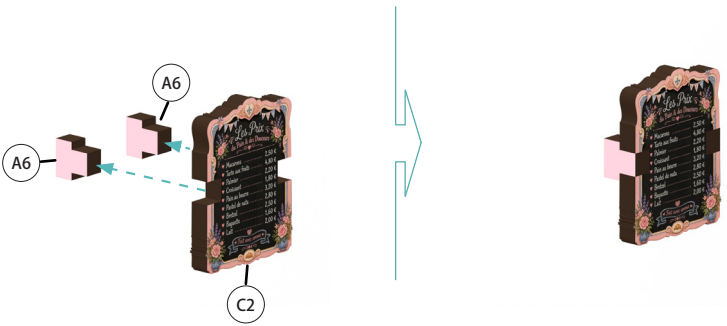

STEP33

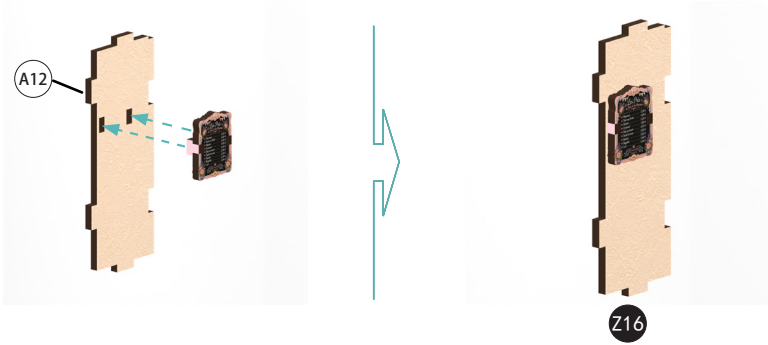

STEP34

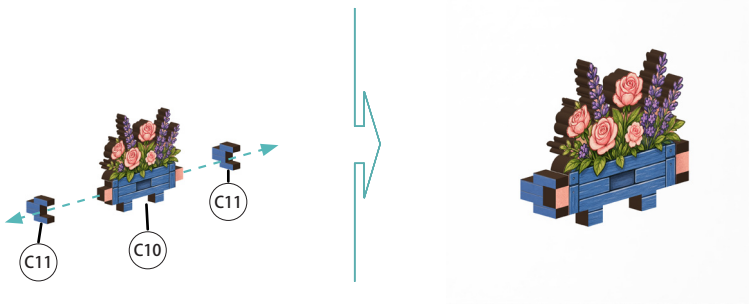

STEP35

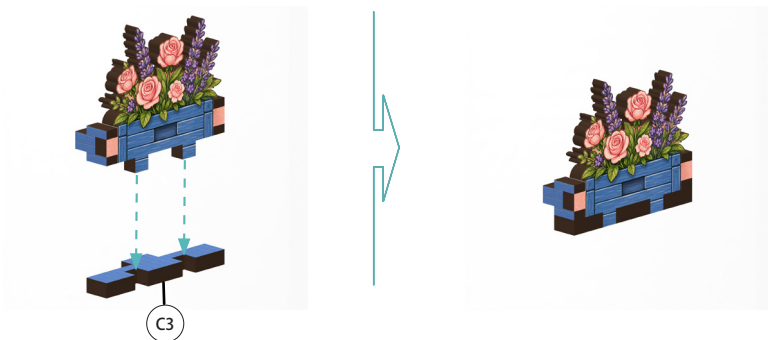

STEP36

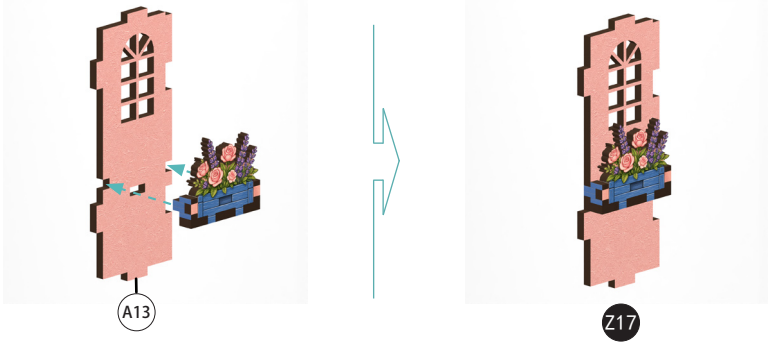

STEP37

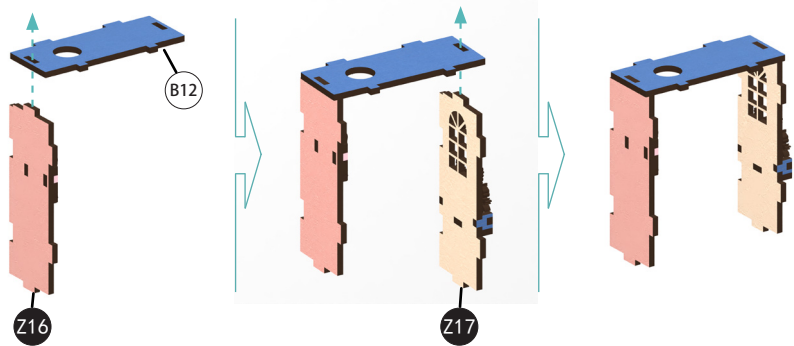

STEP38



STEP39

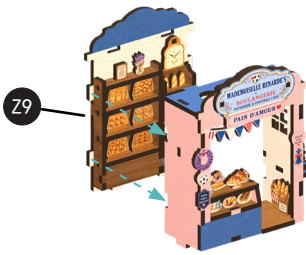

STEP40



STEP41

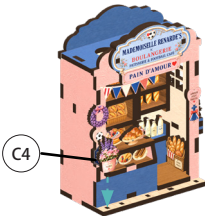

STEP42

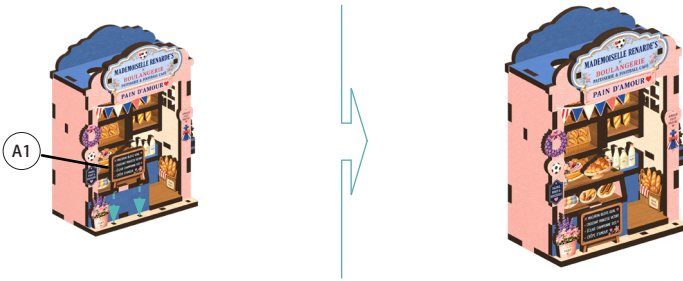

STEP43

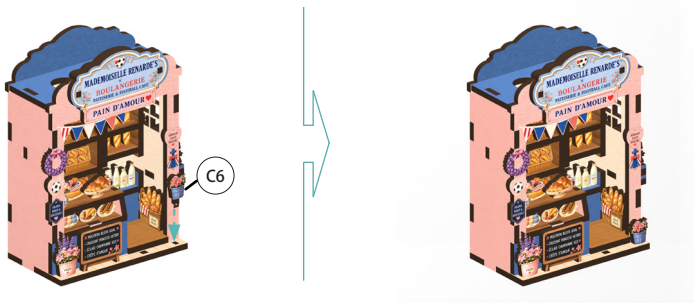

STEP44

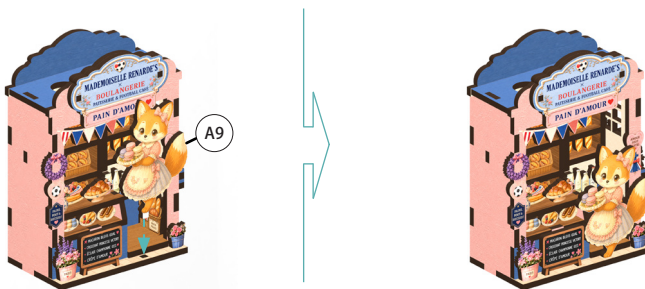

STEP45

灯



STEP46

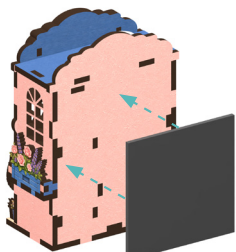

将磁铁的背胶撕去，粘贴于产品背面

